

BLUE SIGNS TO BE INSTALLED WITH HI SPEED CREW AND IPV

Closure details:
A605 Coates Road closed from a point 20m east of the junction with Roman Gardens closed for a further 100m east

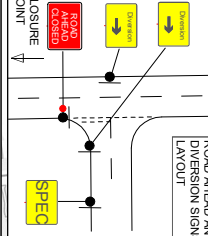
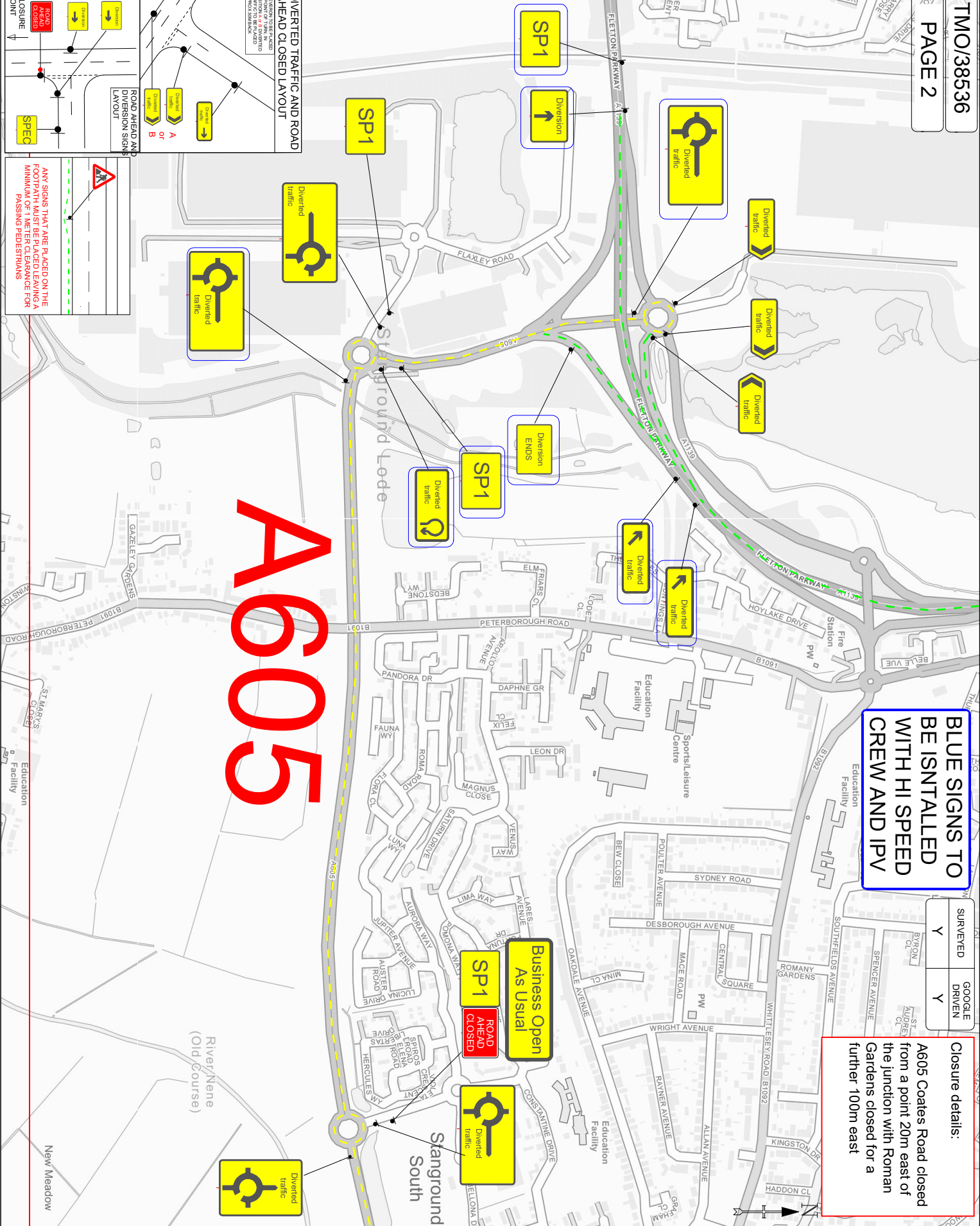

ANY SIGNS THAT ARE PLACED ON THE FOOTPATH MUST BE PLACED LEAVING A MINIMUM OF 1 METER CLEARANCE FOR PASSING PEDESTRIANS

SURVEYED	Y
GOOGLE DRIVEN	Y

TMO-PL-009rev20 | Review date: 01/11/2024

TMO Highways
Building 1, Roy Humphrey Site
A140, Ewe, Suffolk, IP23 9AW
Tel: 01379 676462

Customer Details:
UK Power Networks
Customer Ref: 150092163
Agent: David Monk

Drawing Details:
TM Type: Road closure
Location: COATES ROAD, EASTREA, PET 2BD

Planner: Tom Godbold
Email: tom.godbold@tmohighways.co.uk

- Key**
- Sign Diagram
 - Advances Location
 - Road Closure Location
 - Access Only
 - Diversion Route
 - Sign To Be On A Frame
- Drawn/Revised
- | | | | |
|-----------------|----------|------------|---|
| Drawn by | IG | Revised by | - |
| Date | 15/10/24 | Date | - |
| Revision number | 00 | | |

Main Diversion Route:
A141,
A47,
A1139,
and Vice Versa

TOTAL NUMBER OF SIGNS:- 129

Drawing checked via email by: AV

PLEASE NOTE:
a. All Traffic Management to comply with current chapter 8 and Safety at Street Works and Roadwork's (A code of practice).
b. All road markings and signage to conform to the Traffic Signs Regulations and General Directions 2002.

This Drawing has been produced for the specific client and project as detailed in drawing and customer details and is not intended for any other purposes.